

# FOR SALE

## 1.16± ACRES OF COMMERCIAL LAND



## 2468 CHAMBERS ROAD

### MOLINE ACRES, MO 63136

- 208± Feet of Frontage on Chambers Rd.
- C3 Zoning
- Adjacent to an Existing Fast Food Drive-Thru
- Two (2) Blocks From Highway 367
- Sale Price: \$205,000.00

Contact: Peter A. Pfeifer

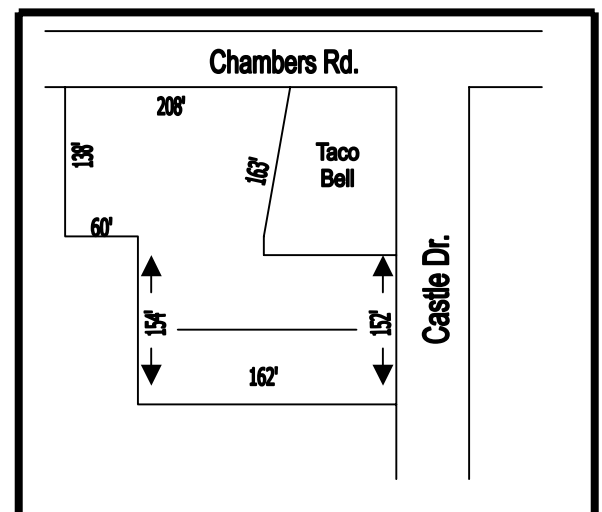

HILLIKER CORPORATION

2001 SOUTH HANLEY ROAD  
SUITE 300 • ST. LOUIS, MO 63144

(314) 781-0001

Commercial • Industrial • Investment  
Real Estate Services

